

PIVOT-PRO

C80 Series Soft-close Mirror Hinges



PRODUCT



DESCRIPTION

- Opening angle: 125°
- Available glass door thickness: 3-6mm
- Adhesion distance (K): 0-16.5mm

APPLICATION

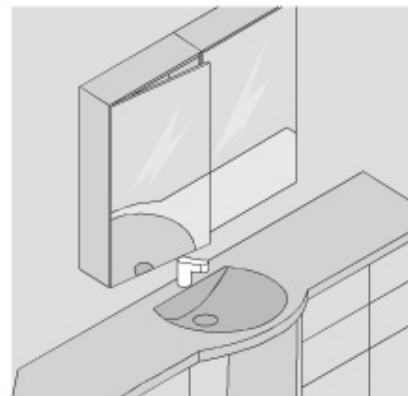

PLANNING

Space needed to open the door

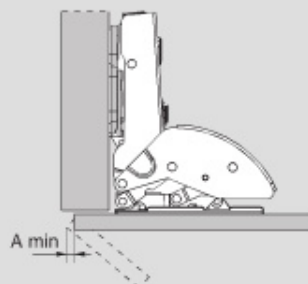

	T=	3	4	5	6									
K=1.5	A=	13.6	14.4	15.2	16.1									
K=3.0	A=	11.2	12.1	12.9	13.8									
K=4.5	A=	8.9	9.8	10.7	11.6									
K=6.0	A=	6.8	7.7	8.6	9.5									
K=7.5	A=	4.2	5.0	5.8	6.6									
K=8.0	A=	2.8	3.8	4.8	5.8									
		-	-	-	-									
K=16.5	A=	0	0	0.3	0.8									

Space needed to open the door

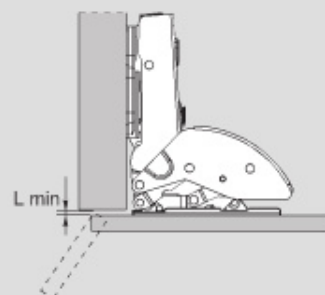

	T=	3	4	5	6									
K=1.5	L=	0	0	0	0									
K=3.0	L=	0	0	0	0									
K=3.5	L=	0	0	0	0									
		-	-	-	-									
K=16.5	L=	0	0	0	0									

- The above values are calculated on the assumption that the doors have square edges.
- They are reduced if the doors have radiused edges.

C=0 Application with full overlay door

D=14mm

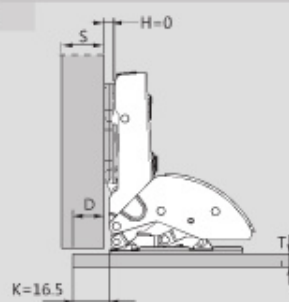

C=7.5 Application with half overlay door

D=6.5mm

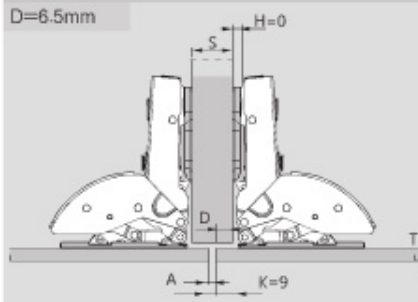

C=15 Application with inset door

A=2.5mm



ORDER INFORMATION



Adhesion distance:

Assembly instructions:
Please contact your glass or door supplier concerning the right adhesive and its use.

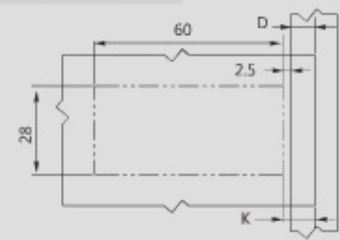

Limitation of liability:

As the adhesive and/or adhesive process are beyond our control, DTC cannot accept liability for claims in this regard.

Use these formulas to determine the type of hinge arm, the adhesion distance "K" and the height of the mounting plate "H" for each door application.

$$K(\min 0, \max 16.5) = D + 2.5$$

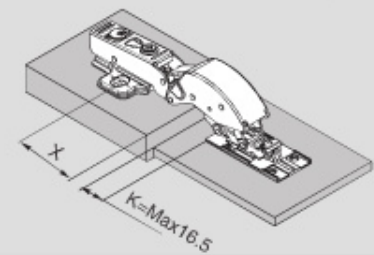

Nickel plated(A01)

Caution

Drilling distance: Full overlay, Half overlay $X=46$, Inset $X=46+T+1$

C80 series snap-on soft close mirror hinge 125° (two way, cam-adjustable)

Full overlay C=0



$$H = -2.5 + K - (D)$$

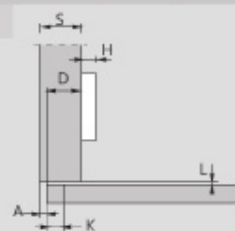

	Item No.	Pcs/ctn
Soft-close	C80A689F	200
Sprung	C80A689	200

Half overlay C=7.5



$$H = -2.5 + K - (D)$$

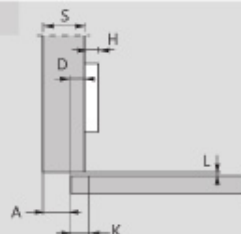

	Item No.	Pcs/ctn
Soft-close	C80A689F	200
Sprung	C80A689	200

Inset C=15



$$H = -2.5 + K + (A)$$

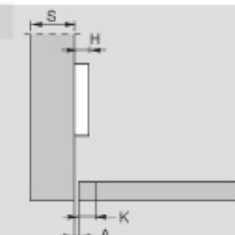

	Item No.	Pcs/ctn
Soft-close	C80A689F	200
Sprung	C80A689	200